

Integrations

CSVEnrichmentSource For Director Console UI

V5.1.0

CONTENTS

1	CSV Enrichment Source	1
2	Installation	2
3	Configuring CSV Enrichment Source in Director Console	5
4	Uninstalling CSV Enrichment Source in Director Console	10

CSV ENRICHMENT SOURCE

CSV Enrichment Source enables you to use a CSV file as an enrichment source in LogPoint. It fetches data feeds from a CSV file and enriches search results with the data. You can either upload a CSV file or provide a URL link to a CSV file.

CSV Enrichment Source supports the following types of CSV files:

1. Tab-separated
2. Comma-separated
3. Space-separated
4. Semicolon-separated

INSTALLATION

Prerequisites

- Director Fabric v1.5.0 or later
- Director Console v1.7.0 or later
- LogPoint v6.9.0 or later

Uploading CSV Enrichment Source in Director Console

1. Click **Assets** from the left navigation bar.
2. Select the **Assets Type** you want to upload.
3. Click the *upload area* to browse, or drag and drop the **CSVEnrichmentSource_5.1.0.pak** file.
4. Click **Upload**.

Once uploaded, the **Assets** page adds the pak file to the list of the available packages in the Fabric Server.

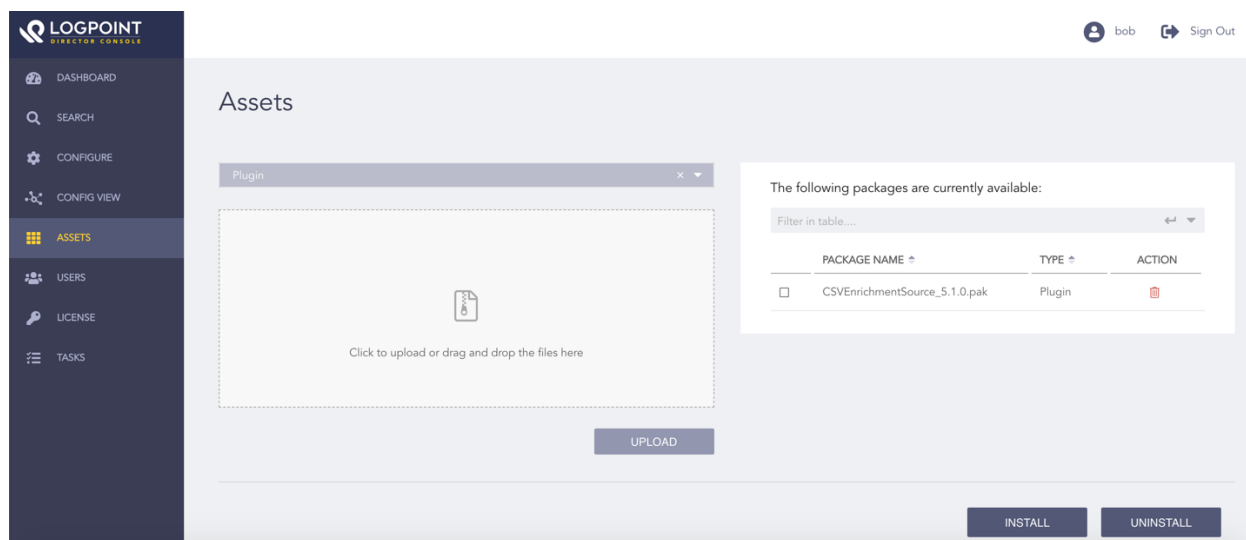

Fig. 1: Uploading CSV Enrichment Source Pak File

Installing CSV Enrichment Source in Director Console

1. Click **Assets** from the left navigation bar.
2. Select **CSVEnrichmentSource_5.1.0.pak** from the list of available packages.
3. Click **Install**.

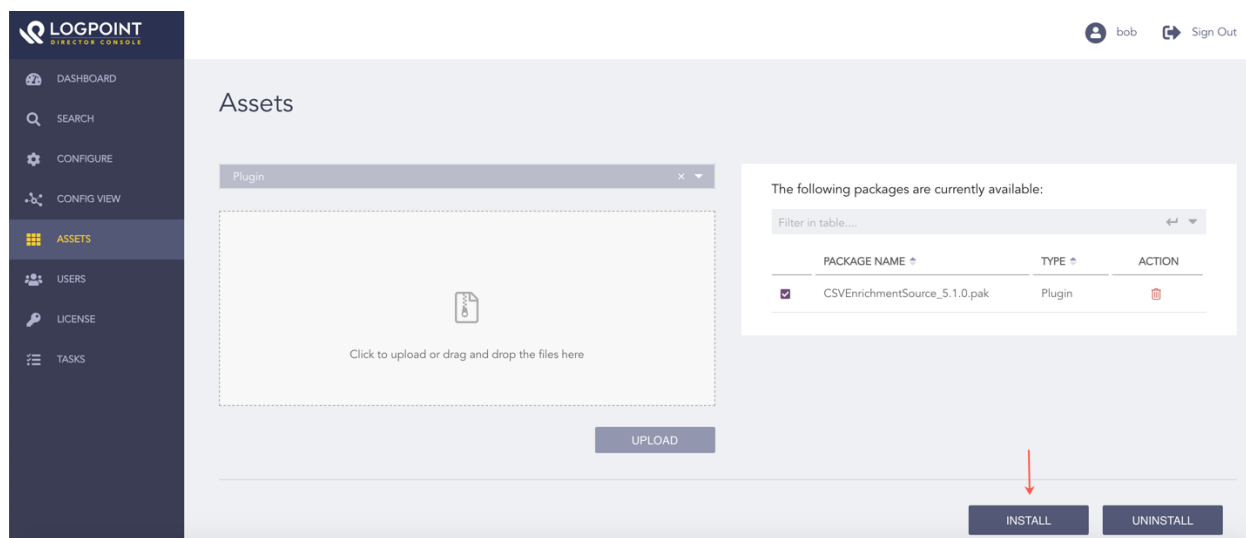

Fig. 2: Selecting the CSV Enrichment Source Package

4. Select LogPoint machines to install CSV Enrichment Source. You can select multiple machines from different pools.

5. Click **Next**.

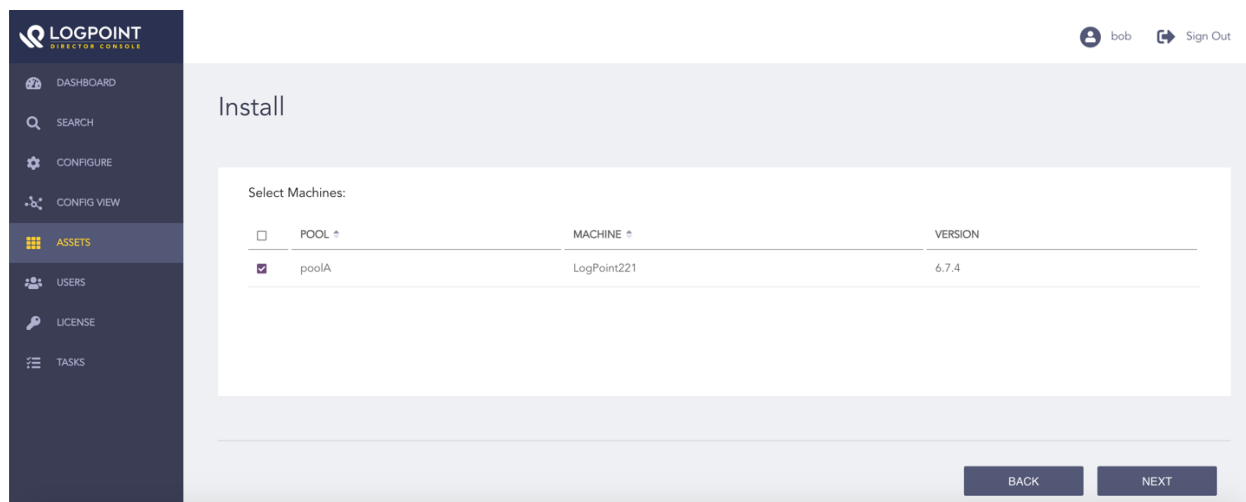

Fig. 3: Selecting LogPoint Machines

6. Review your changes. You can go **Back** to make any changes if necessary.

7. Click **Install**.

8. Click **OK**.

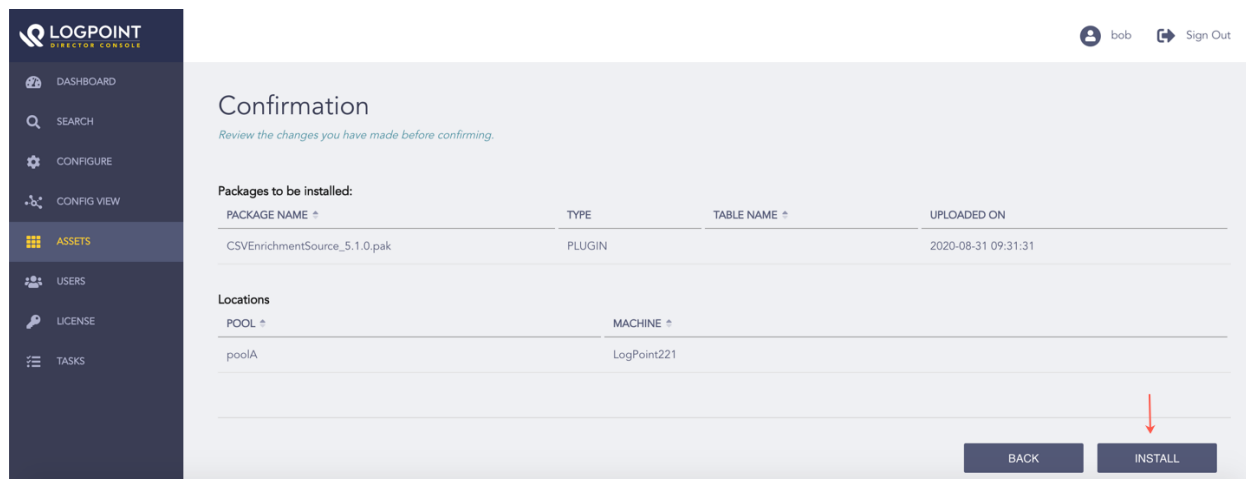

Fig. 4: Confirming the Changes

CONFIGURING CSV ENRICHMENT SOURCE IN DIRECTOR CONSOLE

1. Click **Configure** from the left navigation bar.
2. Click **Plugins**.
3. Select **CSV Enrichment Source** from the **Select Plugin Type** drop-down.
4. Select LogPoint machines to configure CSV enrichment source. You can select multiple machines from different pools.

Note:

- You **cannot** select a subscriber LogPoint to configure CSV enrichment source. The subscriber LogPoint receives these configurations from its provider LogPoint.
 - You can use the **Refresh List** to sync data between LogPoint and Director Fabric.
-

5. Click **Next**.

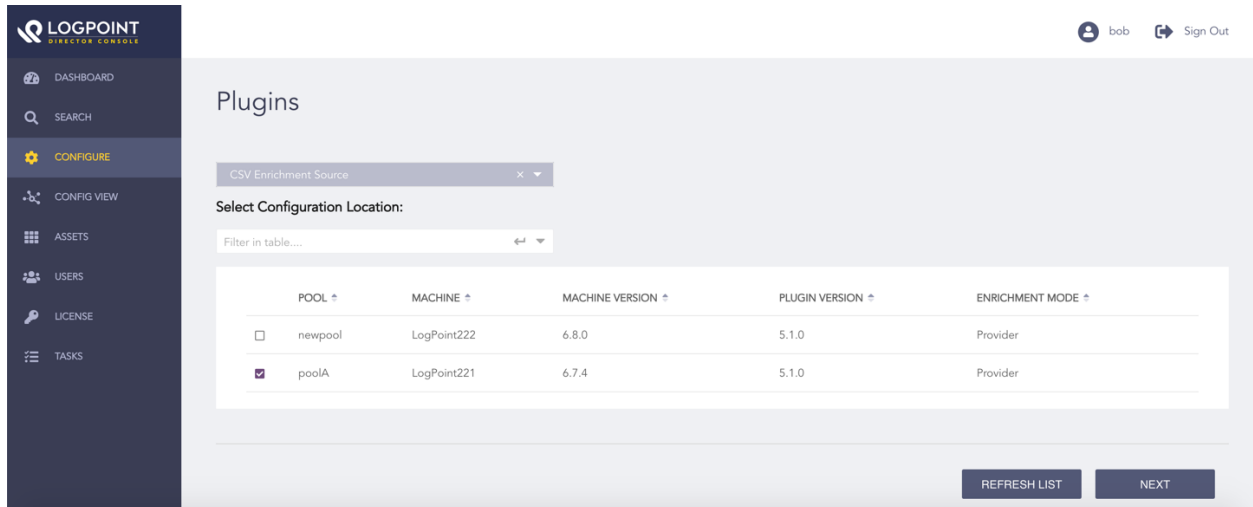

Fig. 1: Selecting LogPoint Machines

6. Enter a **Name**.

7. Select the **Charset**.

8. Select a **Delimiter**. It is the type of data included in the CSV file.

9. Select **Upload Options**.

9.1. Select **File** to provide a CSV file. Click the *upload area* to browse, or drag and drop the CSV file.

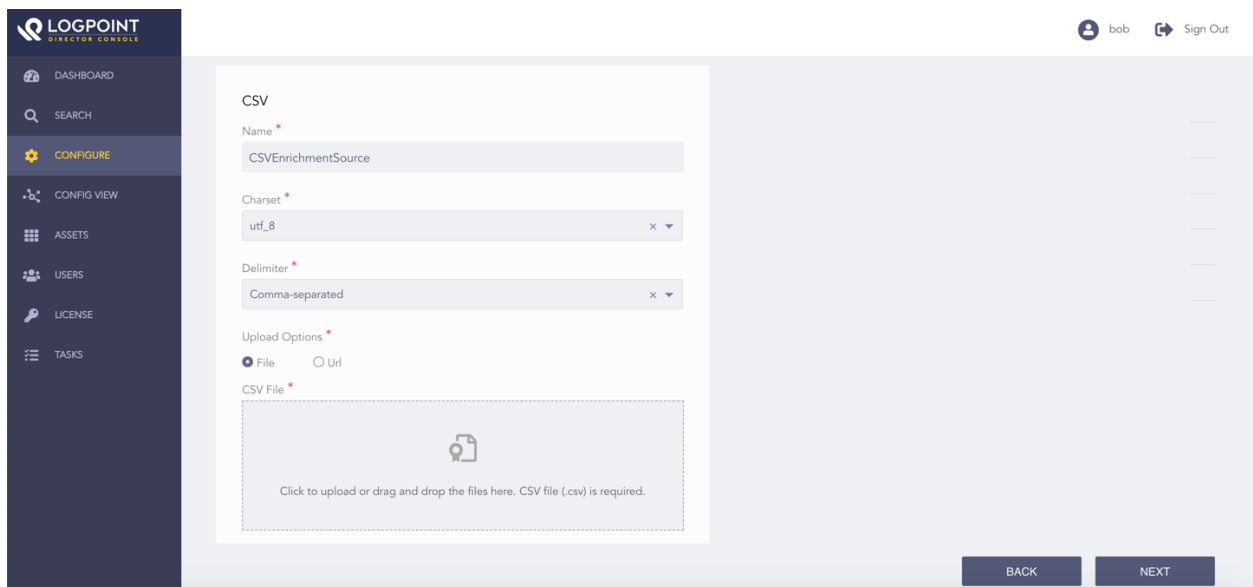

Fig. 2: CSVEnrichmentSource - File Upload

9.2. Select **Url** to upload a URL link to the CSV file.

9.2.1. Enter the **CSV URL** that links to the CSV File.

The screenshot shows the Logpoint Director Console UI. On the left is a dark sidebar with navigation links: DASHBOARD, SEARCH, CONFIGURE (highlighted), CONFIG VIEW, ASSETS, USERS, LICENSE, and TASKS. The main content area is titled 'CSV' and contains the following fields:

- Name**: Text input field containing 'CSVENrichmentSource'.
- Charset**: Dropdown menu showing 'utf_8'.
- Delimiter**: Dropdown menu showing 'Comma-separated'.
- Upload Options**: Radio buttons for 'File' (selected) and 'Url'.
- CSV URL**: Text input field containing 'www.csv/spreadsheet/csvurl.com'.

At the bottom right of the form are two buttons: 'BACK' and 'NEXT'.

Fig. 3: CSVENrichmentSource - Fetch from URL

9.2.2. Select an **Authentication** method.

9.2.2.1. Select **None** if the provided CSV URL requires no authentication.

9.2.2.2. Select **Basic** if the provided CSV URL requires basic authentication. To access the URL, provide your **Username** and **Password**.

The screenshot shows the Logpoint Director Console UI. On the left is a dark sidebar with navigation links: DASHBOARD, SEARCH, CONFIGURE, CONFIG VIEW, ASSETS, USERS, LICENSE, and TASKS. The main content area is titled 'CSV' and contains the following fields:

- Name**: Text input field containing 'CSVENrichmentSource'.
- Charset**: Dropdown menu showing 'utf_8'.
- Delimiter**: Dropdown menu showing 'Comma-separated'.
- Upload Options**: Radio buttons for 'File' (selected) and 'Url'.
- CSV URL**: Text input field containing 'www.csv/spreadsheet/csvurl.com'.
- Authentication**: Radio buttons for 'None', 'Basic' (selected), and 'Key'.
- Username**: Text input field containing 'Bob'.
- Password**: Password input field containing '*****'.

At the bottom right of the form are two buttons: 'BACK' and 'NEXT'.

Fig. 4: CSVENrichmentSource - URL With Basic Authentication

9.2.2.3. Select **Key** if the provided CSV URL requires key-based authentication. To access the CSV file, provide your **API Key**.

Fig. 5: CSVEnrichmentSource - URL With Key Based Authentication

9.2.3. Select **CSV file includes header** if the CSV file contains field headers. If the file does not contain field headers, CSV Enrichment Source assigns default header names as *Column1*, *Column2*, ..., and *ColumnN*, where *N* is the number of columns in your CSV file.

9.2.4. Click **Upload**.

9.2.5. In the **Enrichment Options** section, enter the **Update Interval** in **Day**, **Hour**, and **Minute**.

Fig. 6: CSVEnrichmentSource - Update Interval

10. Click **Next**.

11. Review your changes. You can go **Back** to make any changes if necessary.

12. Click **Finish**.

13. Click **OK**.

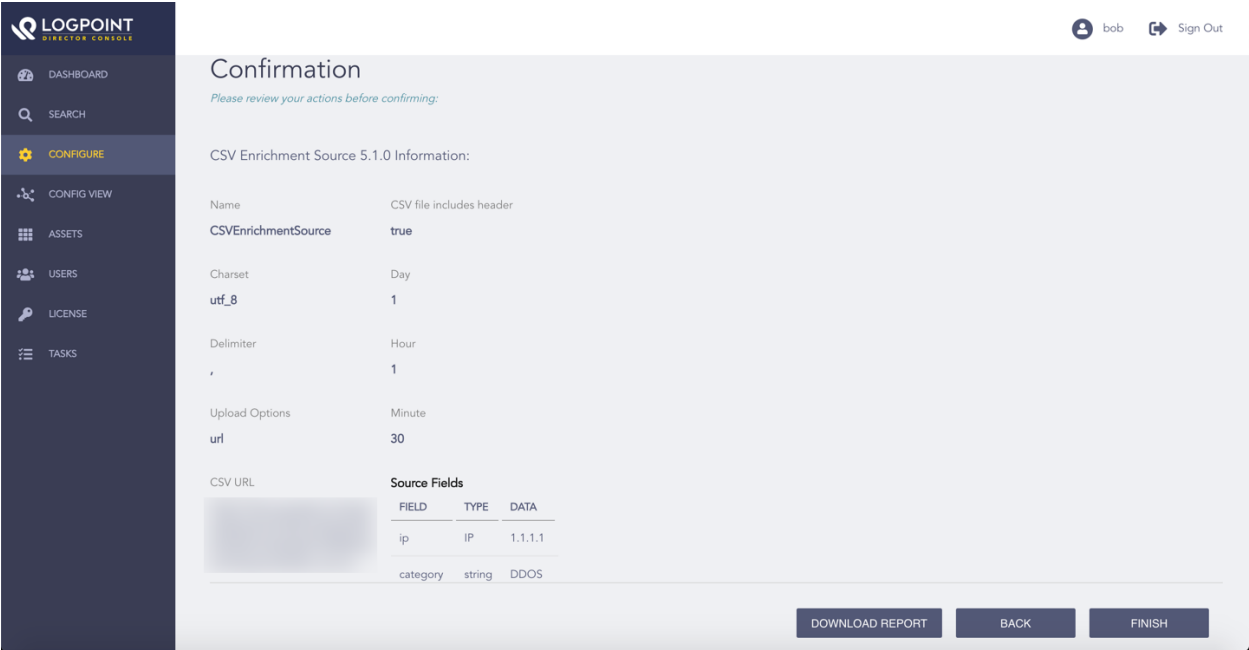

Fig. 7: Confirming the Changes

UNINSTALLING CSV ENRICHMENT SOURCE IN DIRECTOR CONSOLE

1. Click **Assets** from the left navigation bar.
2. Click **Uninstall**.
3. Select LogPoint machines to uninstall CSV Enrichment Source. You can select multiple machines from different pools.
4. Select **CSVEnrichmentSource** from the list of available packages.
5. Click **Next**.

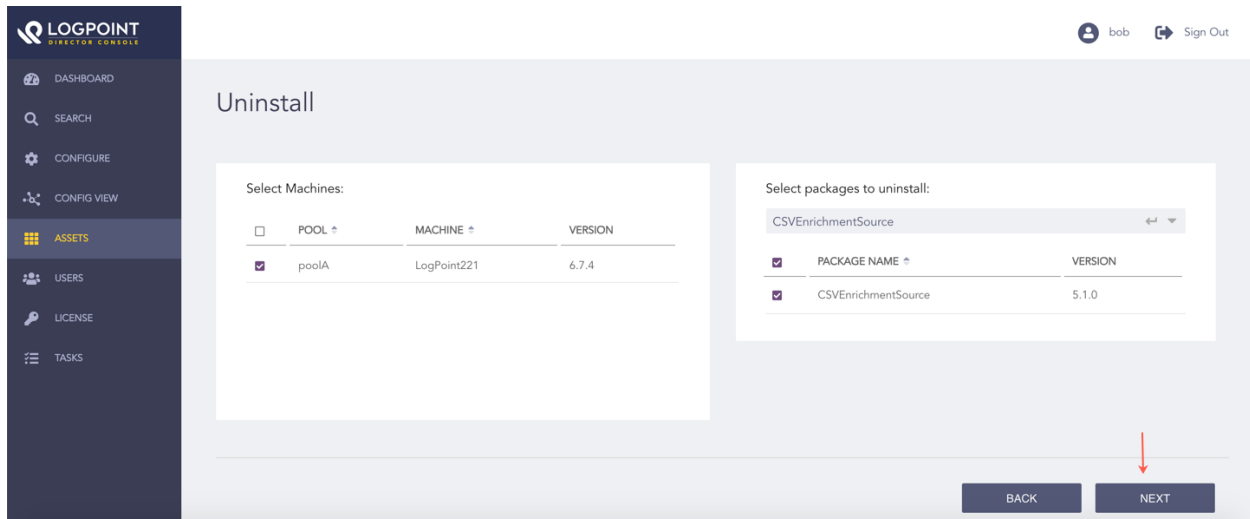

Fig. 1: Selecting LogPoint Machines

6. Review your changes. You can go **Back** to make any changes if necessary.
7. Click **Uninstall**.
8. Click **OK**.

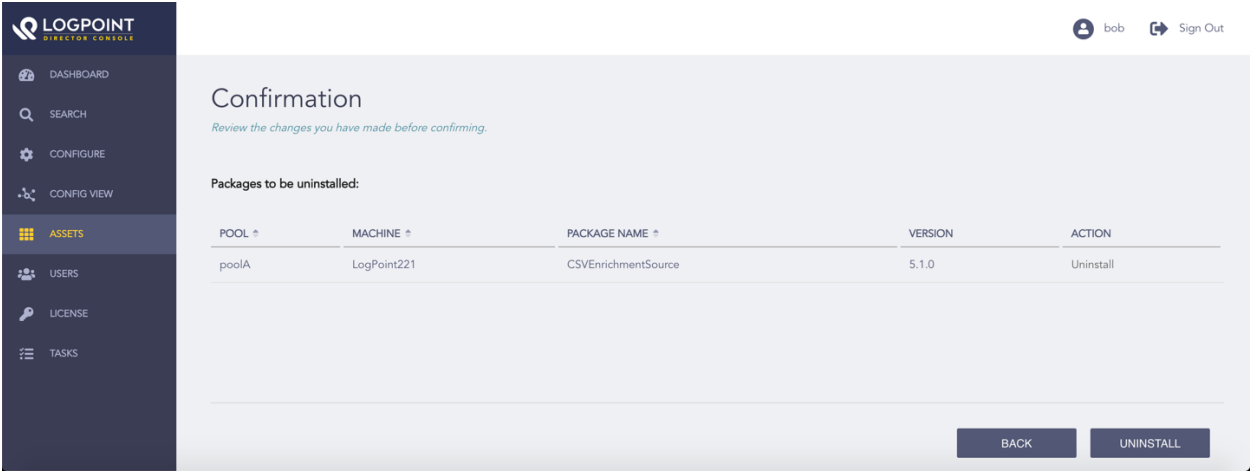

Fig. 2: Confirming the Changes